

Description	Colour	Part number	EAN number
CdS-DIM-FC	white	92589	4007529925896



FC

Accessory	Colour	Part number	EAN number
IR-CdS	white	92577	4007529925773
IR-Adapter for Smartphones	black	92726	4007529927265
Wire basket BSK (Ø 200 x 90 mm)	white	92199	4007529921997

■ TECHNICAL DATA

Voltage:	110 - 240 V AC 50 / 60 Hz
Degree / class of protection:	IP20 / Class II / CE
Ambient temperature:	-25 °C to +50 °C
Housing:	Polycarbonate, UV-resistant
Remote control-capable:	IR-Adapter for Smartphones, IR-CdS
	Channel 1 (lighting control)
Switching power:	2300 W, $\cos \varphi = 1$ 1150 VA, $\cos \varphi = 0.5$
DIM output:	1-10 V DC, up to 50 EB
Lux value:	10 - 2000 Lux
Switch-on delay:	determined automatically
Switch-off delay:	1 min - 30 min

PRODUCT INFORMATION

- Remote controllable, photo electric switch with ability to dim, for ceiling mounting
- Illumination can be dimmed to a desired brightness value. Actual light value can be read and delay time can be set using the optional infrared remote control IR-CdS
- For connection of up to 50 EB
- Constant light regulation
- Dynamic delay

DIMENSIONS DRAWING

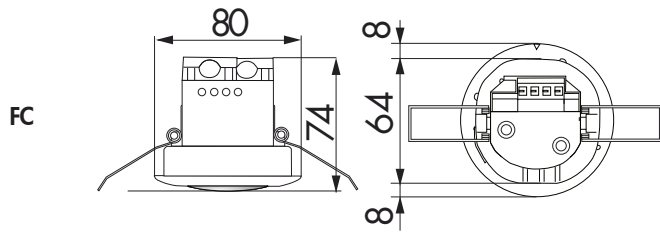

WIRING DIAGRAM

