



LUXOMAT[®] net Indoor 180-KNX-DX

Description	Colour	Part number	EAN number
Indoor 180-KNX-DX-FM covering not included (European version)		93364	4007529933648



FM

Accessory	Colour	Part number	EAN number
IR-Adapter for Smartphones	black	92726	4007529927265
IR-PD-KNX		92123	4007529921232
IR-PD-KNX-Mini		93398	4007529933983
IR-LM Infrared Luxmeter		93030	4007529930302
Indoor 180 socket for wall mounting, IP44	pure white	92141	4007529921416
Covering IP20	pure white	92630	4007529926305
Covering IP20	traffic white	92631	4007529926312
Covering IP20	oyster white	92632	4007529926329
Covering IP20	silver	92633	4007529926336
Covering IP20	anthracite	92634	4007529926343
Frame IP54 for Indoor 180	pure white	92139	4007529921393
Centre plate 56x56	pure white	35126	4007529351268
Centre plate 56x56	pure white	35127	4007529351275
Centre plate 55x55	signal white	39241	4007529392414
Centre plate 55x55	pure white	39222	4007529392223
Centre plate 45x45	traffic white	38947	4007529389476
Centre plate 45x45	oyster white	39076	4007529390762
Centre plate 55x55	pure white	39242	4007529392421

■ TECHNICAL DATA

Voltage:	24 V DC via KNX BUS
typ. power input:	12 mA
Detection area:	180°
Recommended mounting height:	1.1 - 2.2 m
Range:	max. 10 m across max. 3 m towards
Degree / class of protection:	IP20 / Class II
Operation mode:	Intelligent semi-automatic mode, Occupancy-independent regulating mode (photoelectric switch), Full automatic mode
HVAC operation modes:	1=Comfort, 2=Standby, 3=Economy, 4=Heat protection
Ambient temperature:	-25 °C to +55 °C
Temperature measuring range:	-5 °C to +45 °C
Housing:	Polycarbonate, UV-resistant
Number of PIR sensors:	1
Remote control-capable:	IR-Adapter for Smartphones, IR-PD-KNX, IR-PD-KNX-Mini
Outputs:	1x light (for regulating or switching), 1x Slave, 3 separate HVAC outputs
Orientation light:	10 % - 100 % / OFF / 1 min - 255 min
Night light:	10 % - 100 %
Brightness set value:	5 - 2000 Lux

i PRODUCT INFORMATION

- KNX occupancy detector with integrated KNX bus connector
- Individual adaption of the motion sensor sensitivity
- Detection area can be extended thanks to master-slave-mode
- Extensive optimization options for light measurement
- Measured light value is communicated to the bus
- Adaption of dimming curve
- Measuring of mixed light thanks to internal light sensor
- Determination of the reflection factor, e.g. on a desk, with the optional Infrared Luxmeter IR-LM
- Remote control capable (IR) via B.E.G. LUXOMAT® Remote Control App for Smartphones (IR-Adapter required)
- PIN code
- IR remote control-capable via IR remote control (optionally)
- IR remote control-capable via 5 button remote control, programmable at choice (accessory)
- Programming button (phys. address) can be operated via remote control
- Regulation/switching of three light groups via offset (external influence possible)
- Manual influence via external KNX push buttons possible
- Function control (heartbeat, cyclical sending)
- Short presence, self-adjusting follow-up time
- Occupancy simulation
- Forced switch-off
- Two logic modules
- Intelligent central-off function
- Recall of light scenes
- Premonition of switch-off
- Behaviour upon bus voltage return definable at choice
- Variable safety pause after switching off the lights
- Temperature- and noise sensor
- Settings ex ETS 4 for integration in KNX systems
- The product database for import into the ETS database can be downloaded from the B.E.G. homepage.
- For use with covering (interior cover dimensions 50x50mm) in 5 different colours
- With centre plate suitable for all current flush-mount switch programs

DIMENSIONS DRAWING

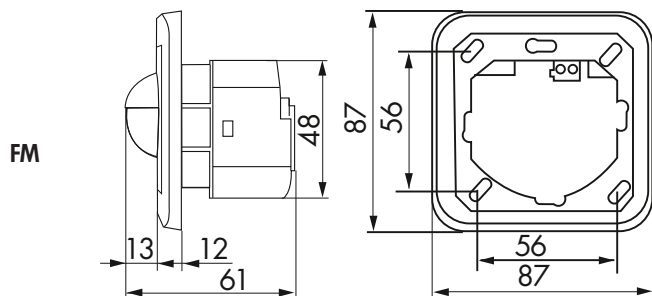

WIRING DIAGRAM

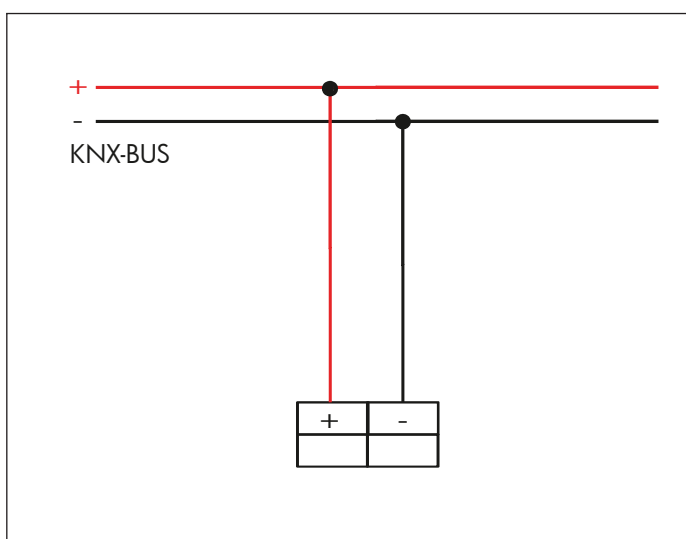

RANGE DIAGRAM

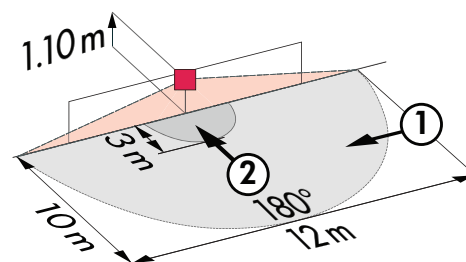

- ① Walking across
- ② Walking towards