

LUXOMAT® TS-DD



■ TECHNICAL DATA

- 230V~ ±10%
- Light sensors:**
IP54 / Class II / CE
- Photocell:**
L 64 x W 17.5 x H 90 mm
- Light sensors:**
L 63 x W 38 x H 58 mm
- Light sensors:**
-35°C to +50°C
- made of high-quality and UV-resistant polycarbonate

Channel 1 (light control)

- Bulb load**
1000 W, cosφ = 1
- Fluorescent lamp compensated**
600 W
- Halogen lamps**
450 W
- Activation delay:**
approx. 8 sec.
- Deactivation delay:**
approx. 40 sec.
- 1 - 100 Lux / 50 - 1000 Lux

PRODUCT INFORMATION

- LUXOMAT® TS-DD photocell for DIN-rail
- Electronic component for installation in branches for comfortable settings from switch cabinets
- Separate light sensor for surface or flush installation (included)
- Switches off at around 1.3 times the activation value
- When setting the desired lux value, a diode will light up when the lux values equal the strength of the momentary amount of daylight, without taking account of the delay of around 20 sec.
- **Application examples:**
ideal for entrance areas, staircases, halls where permanent light is required

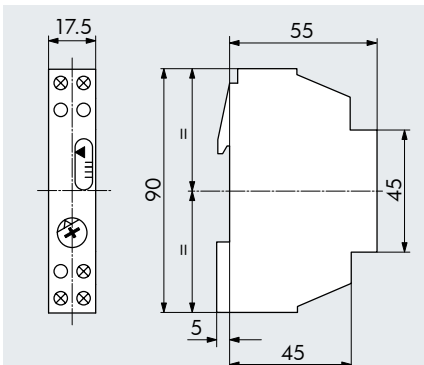

Photocell

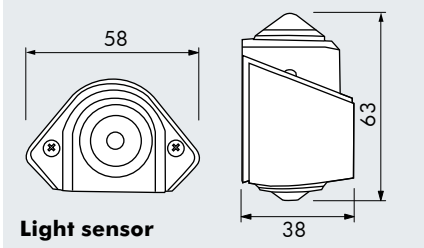

Light sensor



Description	Colour	Part number
TS-DD	white	92681